



KBP2005 THRU KBP210

Single Phase 2.0 AMPS. Glass Passivated Bridge Rectifiers

Voltage Range: 50 to 1000 Volts Current: 2.0 Amperes

Features

- UL Recognized File # E-230084
- Ideal for printed circuit board
- Reliable low cost construction technique results in inexpensive product
- High temperature soldering guaranteed:
250°C / 10 seconds / 0.375" (9.5mm)
lead length at 5 lbs., (2.3 kg) tension

Mechanical Data

- Case: Molded plastic
- Lead: solder plated
- Polarity: As marked

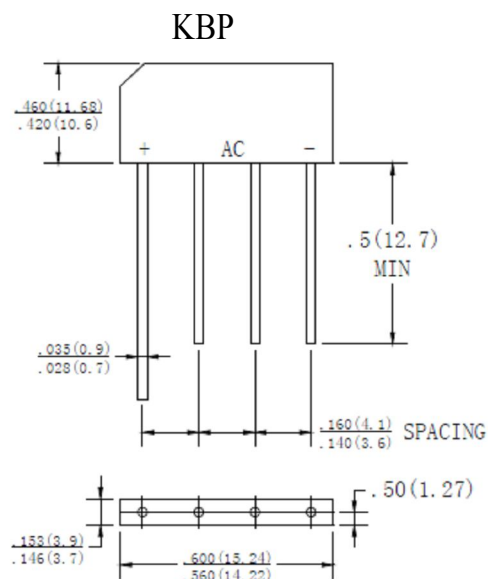

Dimensions in inches and (millimeters)

MAXIMUM RATINGS AND ELECTRICAL CHARACTERISTICS

Rating at 25°C ambient temperature unless otherwise specified.

Single phase, half wave, 60 Hz, resistive or inductive load.

For capacitive load, derate current by 20%

Type Number		KBP 2005	KBP 201	KBP 202	KBP 204	KBP 206	KBP 208	KBP 210	UNITS
Maximum Repetitive Peak Reverse Voltage	V _{RRM}	50	100	200	400	600	800	1000	V
Maximum RMS Voltage	V _{RMS}	35	70	140	280	420	560	700	V
Maximum DC blocking Voltage	V _{DC}	50	100	200	400	600	800	1000	V
Maximum Average Forward Rectified Current @TA=50°C	I _(AV)	2.0							A
Peak Forward Surge Current, 8.3 ms Single Half Sine-wave Superimposed on Rated Load (JEDEC method)	I _{FSM}	60							A
Maximum Instantaneous Forward Voltage @ 3.14A	V _F	1.2							V
Maximum DC Reverse Current @ TA=25°C rated DC blocking voltage per leg TA = 125°C	I _R	10 500							μA
Typical Thermal Resistance (Note)	R _{θJA} R _{θJL}	25 8.0							°C/W
Operating Temperature Range	T _J	-55 to +150							°C
Storage Temperature Range	T _{STG}	-55 to +150							°C

NOTE : Thermal Resistance from Junction to Ambient and from Junction to Lead Mounted on P.C.B. with 0.47X0.47"(12X12mm)

Copper Pads

RATING AND CHARACTERISTIC CURVES

FIG.1-MAXIMUM NONO-REPETITIVE FORWARD SURGE CURRENT PER BRIDGE ELEMMENT

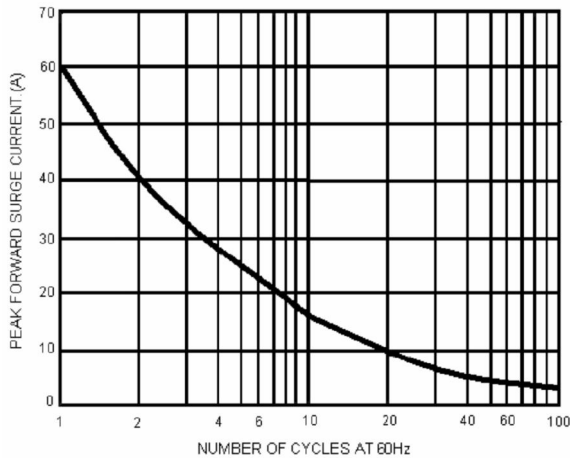

FIG.2-MAXIMUM FORWARD CURRENT DERATING CURVE

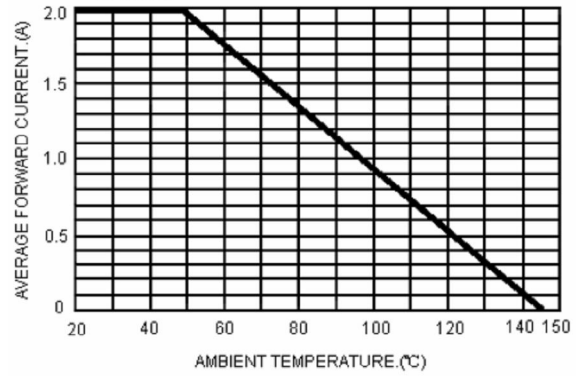

FIG.3-TYPICAL INSTANTANEOUS FORWARD CHARACTERISTICS PER BRIDGE ELEMENT

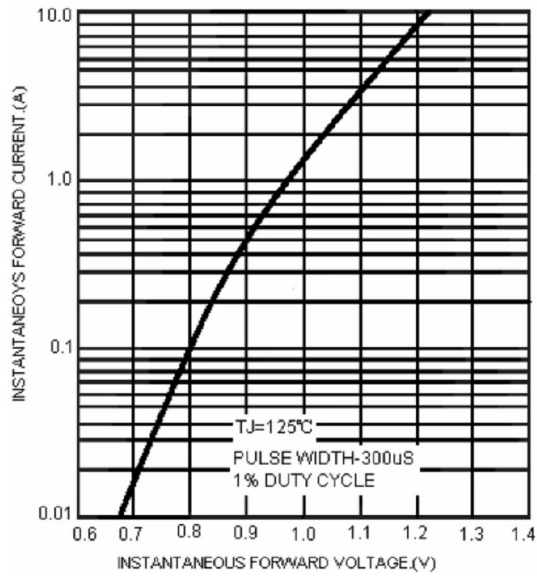

FIG.4-TYPICAL REVERSE CHARACTERISTICS PER BRIDGE ELEMENT

